



## FEATURES

- No scheduled maintenance required for oxygen sensor
- Long-life, self-calibrating CO2 sensor
- Local backlit concentration display
- Built-in audible horn
- Built-in visual LED alarm indicators
- Alarm level 1 for CO2, and Alarm Level 2 for O2
- No drift due to environmental or temperature changes
- 3-year warranty
- Built-in Flow Sample Pump

## Why choose PureAir?

PureAir Monitoring Systems, Inc. is an industry leader in oxygen monitoring and gas detection. For over 20 years, we have dedicated ourselves to the safety of our clients, and the customers they serve, by manufacturing monitors that are long-lasting, accurate, and reliable. PureAir takes pride in providing exceptional customer service along with 24/7 availability to their technical service department.

## What is a Water Resistant Sample Draw O2/CO2 Monitor?

The Water Resistant Sample Draw O2/CO2 Monitor is designed for continuous, remote sampling where low oxygen levels and high levels of carbon dioxide pose a hazard to personnel.

## What gases can be detected with a Water Resistant Sample Draw O2/CO2 Monitor?

PureAir's water resistant sample draw dual O2/CO2 monitor continuously measures oxygen and carbon dioxide levels in an ambient atmosphere where inert gases, including nitrogen, argon, helium, and carbon dioxide are used.

## Easy to Use

Secure the monitor to the wall so the display is visible, place the remote sensor up to 100 feet from the monitor, and connect the monitor to a 24VDC 300mA power source. The monitor will begin sampling O2/CO2 levels after a brief startup period. O2/CO2 levels are displayed clearly on the screen for easy access and visibility.

## IP67 Water Resistant Sample Draw Dual O2/CO2 Monitor with 10+ Year Sensor

ITEM #: TX-1100 (99127)

### Product Summary

The Water-Resistant Sample Draw Dual O2/CO2 Monitor is a self-contained system that is designed for continuous monitoring of inert gases in confined spaces that require daily wash-downs. The monitor can sample O2/CO2 levels from up to 100 feet away and is ideal for facilities that use inert gases including, but not limited to, nitrogen, helium, and argon. Its IP67 water resistant enclosure keeps the monitor dry during wash-downs. The O2/CO2 monitor is perfect for environments such as breweries, bottling plants, food processing facilities, and laboratories. The monitor will remain accurate at temperatures as low as -40C. PureAir's durable, non-depleting, zirconium oxide sensor cells, and NDIR cells, will last up to 10+years in a normal environment, without needing to be replaced.

### Facilities That Need This Product

- *Laboratories*
- *Breweries and Bottling Plants*
- *Biomedical*
- *Food Processing*
- *Flash Freezing Tunnels*
- *Freezers*

# Top Advantages of Oxygen Deficiency Monitor



## Oxygen Deficiency Alarm

PureAire's O2 Monitor comes with 2 adjustable alarm setpoints that can connect to a horn/strobe, exhaust fan, 8 channel controller, remote display, or into building systems. Alarm signals also can tie into automatic shut-off valves when oxygen levels fall below the OSHA threshold.

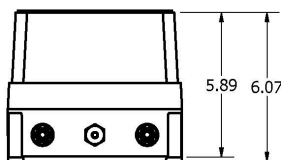
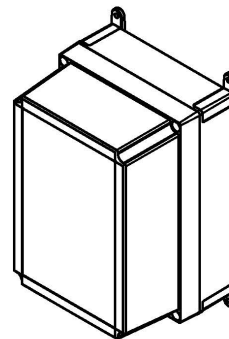
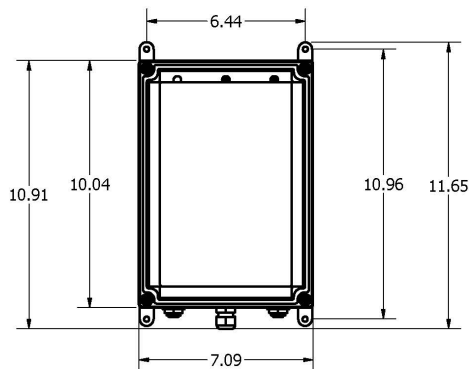

## Top Accessories



**8 Channel Programmable  
Controller for O2 or Gas  
Monitors**  
ITEM #: 99196



**Remote Digital  
Display**  
ITEM #: 99091



**Red Horn/Strobe  
24VDC**  
ITEM #: 42002



**1-905-335-6040**  
info@puritygas.ca  
www.puritygas.ca

Purity Gas, Inc.  
10-1469 Sandhill Drive  
Ancaster, ON L9G 0H7